

pinkfong  
**BABY SHARK™**

© Smart Study Co., Ltd. All Rights Reserved. Pinkfong® and Baby Shark™ are trademarks of Smart Study Co., Ltd. © 2020 Viacom International Inc. All Rights Reserved. Nickelodeon is a trademark of Viacom International Inc.

**Musical Playpad**



**WowWee Group Limited.**

Energy Plaza, 301A-C, 92 Granville Road T.S.T. East, Hong Kong

**WowWee Canada Inc.**

3700 Saint Patrick Street, Suite 206, Montreal QC, H4E 1A2, Canada

**Consumer Service:**

<https://support.wowwee.com>

Age: 6M+

**USER MANUAL**

**Package Contents:**

1 x Musical Playpad, 2 x Removable Stands, 1 x User Manual

Required:

3 x "AAA" 1.5V LR03/R03 (included)

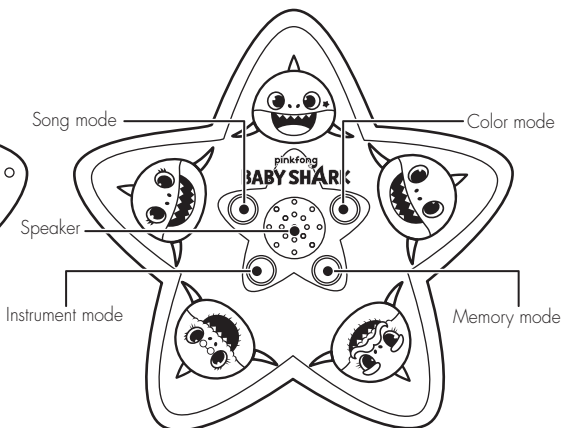
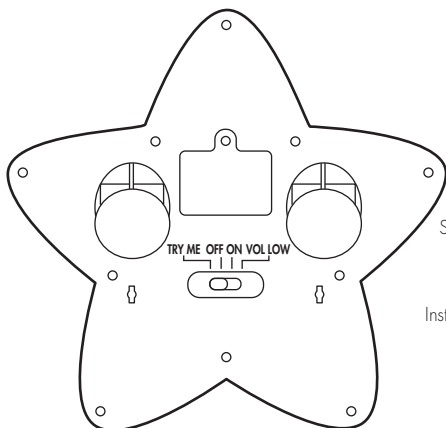

**Baby Shark**



**Daddy Shark**



**Mommy Shark**



**Grandpa Shark**



**Grandma Shark**

**Song mode:**

Press the song mode button to enter song mode. Press each Shark Character Button to play a different song.

**Instrument mode:**

Press the instrument button to toggle between different instruments like drums, piano, guitar, trumpet and flute. Press the Shark Character Buttons to play different instrument notes of the instrument that was selected.

**Color mode:**

Press the color mode button to have Baby Shark™ quiz you on your colors. Where is yellow, pink, blue, orange and green? Press the Shark Character Buttons to match it. Baby Shark will let you know if you are right or you should try again.

**Memory mode:**

Press the memory mode button, to play the memory game with Baby Shark™. Each sequence starts with one color or character. Press the correct Shark Character Button accordingly. With every correct answer the sequence gets longer. Choose wrong and the game starts over.

## INSTALLATION

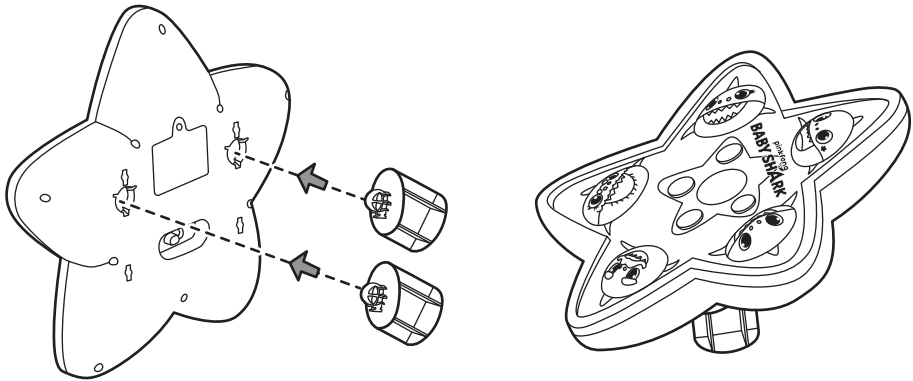

## BATTERY INFORMATION

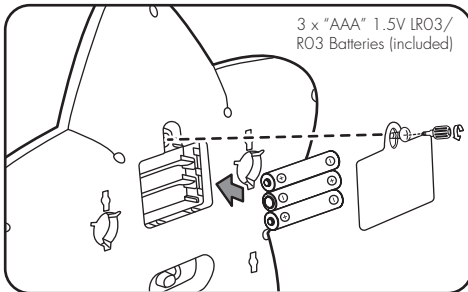

Battery Diagram/Installation

### IMPORTANT BATTERY INFORMATION:

- Use only fresh batteries of the required size and recommended type.
- Do not mix old and new batteries, different types of batteries [standard (Carbon-Zinc, Alkaline or rechargeable)] or rechargeable batteries of different capacities.
- Remove rechargeable batteries from the toy before recharging them.
- Rechargeable batteries are only to be charged under adult supervision.
- Please respect the correct polarity, (+) and (-).
- Do not try to recharge non-rechargeable batteries.
- Do not dispose of batteries into fire.
- Replace all batteries of the same type/brand at the same time.
- The supply terminals are not to be short-circuited.
- Remove exhausted batteries from the toy.
- Batteries should be replaced by adults.
- Batteries should be recycled or disposed of as per state and local guidelines.
- Protect the environment by not disposing of this product with household waste. Check your local authority for recycling advice and facilities.



Manufactured and distributed by WowWee Group Limited. © Smart Study Co., Ltd. All Rights Reserved. Pinkfong® and Baby Shark™ are trademarks of Smart Study Co., Ltd. © 2020 Viacom International Inc. All Rights Reserved. Nickelodeon is a trademark of Viacom International Inc.

"Baby Shark" song arranged by Pinkfong® and KizCastle, and performed by KizCastle, Sarah Bock, Andy Degan, Finn Phoenix and Bommie Catherine Han.

Customer Service Website: <https://support.wowwee.com>

We recommend that you retain our address for future reference.

Product and colors may vary.

Packaging printed in China.

CAN ICES-3(B)/NMB-3(B)

MADE IN CHINA

### CAUTION

Changes or modifications not expressly approved by the party responsible for compliance could void the user's authority to operate the equipment.

### NOTE

This equipment has been tested and found to comply with the limits for a class B digital device, pursuant to part 15 of the FCC rules. These limits are designed to provide reasonable protection against harmful interference in a residential installation. This equipment generates, uses and can radiate radio frequency energy and, if not installed and used in accordance with the instructions, may cause harmful interference to radio communications.

However, there is no guarantee that interference will not occur in a particular installation. If this equipment does cause harmful interference to radio or television reception, which can be determined by turning the equipment off and on, the user is encouraged to try and correct the interference by one or more of the following measures:

- Reorient or relocate the receiving antenna
- Increase the separation between the equipment and receiver
- Connect the equipment into an outlet on a circuit different from that to which the receiver is connected
- Consult the dealer or experienced radio/TV technician for help

This Device complies with Part 15 of the FCC Rules. Operation is subject to the following two conditions: (1) This device may not cause harmful interference, and (2) This device must accept any interference received, including interference that may cause undesired operation.

For these purposes, the party responsible is:

WowWee USA Inc.

7855 Fay Avenue, Suite 310, La Jolla, CA, USA 92037

1-800-310-3033

For full list of inputs, please visit <http://wowwee.com/babyspark>

For warranty information, please visit <http://wowwee.com/information/warranty>

**WARNING!** This equipment may experience difficulty and/or memory loss when subjected to any electrostatic discharge, radio frequency interference, or sudden power surge/interruption. The user is encouraged to reset the equipment should any of these occur.



61226US02TOP\_MIM