

Please note the following when operating Untamed Legends Dragon:

- Do not immerse Untamed Legends Dragon or any of its parts in water or any other form of liquid.
- Do not drop, throw, or kick Untamed Legends Dragon as this may damage mechanical functions.
- Do not leave Untamed Legends Dragon unattended near edges from which it could fall.
- Avoid excessive force when turning head or opening mouth manually.

IMPORTANT BATTERY INFORMATION:

- Use only fresh batteries of the required size and recommended type.
- Do not mix old and new batteries, different types of batteries [standard (Carbon-Zinc), Alkaline or rechargeable] or rechargeable batteries of different capacities.
- Remove rechargeable batteries from the toy before recharging them.
- Rechargeable batteries are only to be charged under adult supervision.
- Please respect the correct polarity, (+) and (-).
- Do not try to recharge non-rechargeable batteries.
- Do not dispose of batteries into fire.
- Replace all batteries of the same type/brand at the same time.
- The supply terminals are not to be short-circuited.
- Remove exhausted batteries from the toy.
- Batteries should be replaced by adults.
- Batteries should be recycled or disposed of as per state and local guidelines.
- Protect the environment by not disposing of this product with household waste. Check your local authority for recycling advice and facilities.



Manufactured and distributed by WowWee Group Limited. Fingerlings® and all product names, designations, and logos are trademarks or registered trademarks of WowWee Group Limited. Copyright 2019 WowWee Group Limited. All rights reserved. Patent Pending.

Customer Service Website: <https://support.wowwee.com>

We recommend that you retain our address for future reference.

Product and colors may vary.

Packaging printed in China.

WARNING! This product is not suitable for children under 3 years because of small parts - choking hazard.

CAN ICES-3(B)/NMB-3(B)

MADE IN CHINA

CAUTION

Changes or modifications not expressly approved by the party responsible for compliance could void the user's authority to operate the equipment.

NOTE

This equipment has been tested and found to comply with the limits for a class B digital device, pursuant to part 15 of the FCC rules. These limits are designed to provide reasonable protection against harmful interference in a residential installation. This equipment generates, uses and can radiate radio frequency energy and, if not installed and used in accordance with the instructions, may cause harmful interference to radio communications.

However, there is no guarantee that interference will not occur in a particular installation. If this equipment does cause harmful interference to radio or television reception, which can be determined by turning the equipment off and on, the user is encouraged to try and correct the interference by one or more of the following measures:

- Reorient or relocate the receiving antenna
- Increase the separation between the equipment and receiver
- Connect the equipment into an outlet on a circuit different from that to which the receiver is connected
- Consult the dealer or experienced radio/TV technician for help

This Device complies with Part 15 of the FCC Rules. Operation is subject to the following two conditions:

- (1) This device may not cause harmful interference, and
- (2) This device must accept any interference received, including interference that may cause undesired operation.

For these purposes, the party responsible is:

WowWee USA Inc.

7855 Fay Avenue, Suite 310, La Jolla CA, USA 92037

1-800-310-3033

For a full list of inputs, please visit <http://wowwee.com/fingerlings>

For more information, please visit <http://untamed.wowwee.com>

For warranty information, please visit <http://wowwee.com/information/warranty>

WARNING! This equipment may experience difficulty and/or memory loss when subjected to any electrostatic discharge, radio frequency interference, or sudden power surge/interruption. The user is encouraged to reset the equipment should any of these occur.



WowWee Group Limited

Energy Plaza, 301A-C
92 Granville Road
T.S.T. East, Hong Kong

WowWee Canada Inc.

3700 Saint Patrick Street
Suite 206, Montreal, QC
H4E 1A2, Canada



3956US01SUN_MIM



Manufactured and distributed by
© 2019 WowWee Group Limited.
All Rights Reserved. Patent Pending.

Customer Service:
More information on:
<https://support.wowwee.com>

WowWee Group Limited. Energy Plaza, 301A-C
92 Granville Road
T.S.T. East, Hong Kong

WowWee Canada Inc. 3700 Saint Patrick Street
Suite 206, Montreal, QC
H4E 1A2, Canada



Package Contents:

1 x Untamed Legends Dragon,
1 x User Manual

Required:

4 x 1.5V "AAA/LR03" Alkaline Batteries
(not included)

Age: 5+

USER MANUAL

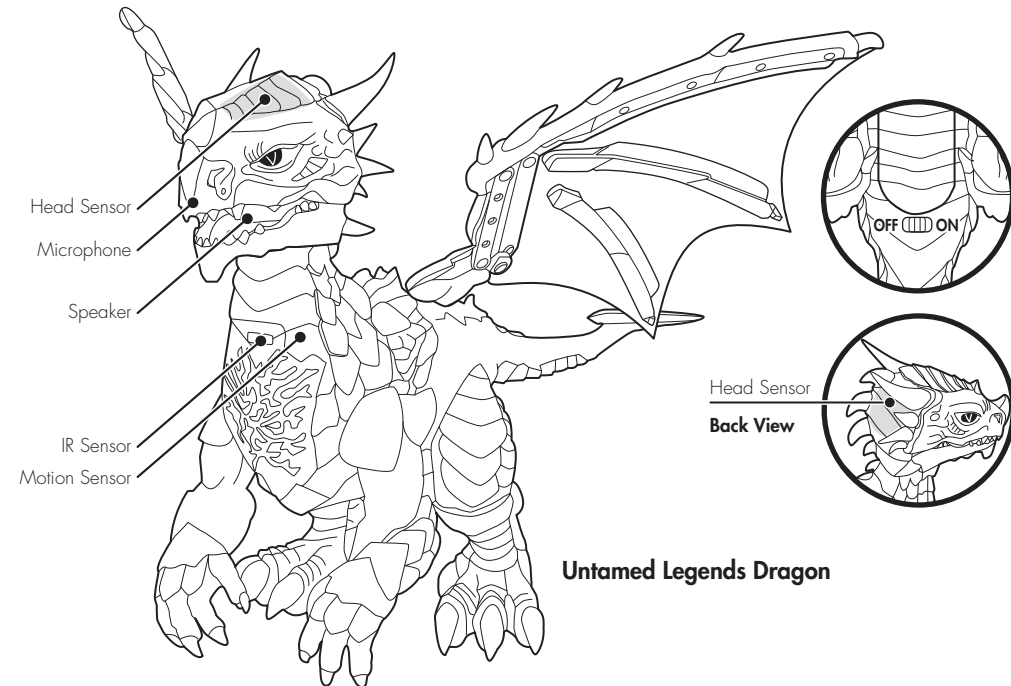

Untamed Legends Dragon

Foldable wings:

Fold wings manually by gently pushing them inward. Wings will extend automatically in Untamed mode.

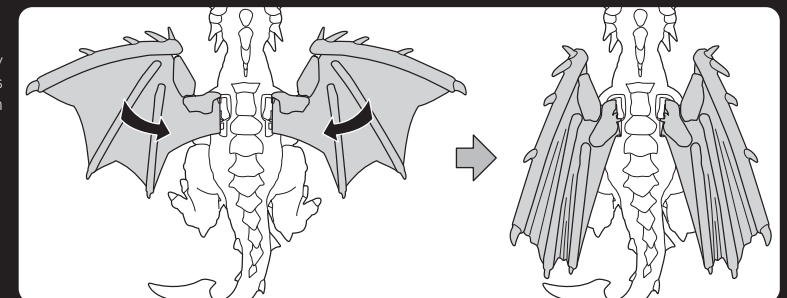

TAMED VS UNTAMED

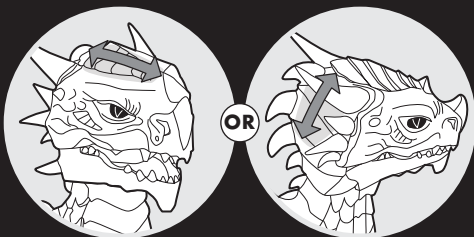

Tame Mode:

Stroke head sensors once or continuously to hear him purrr happily.



Untamed Mode:

Tap head sensors once or continuously to hear him growl, hiss, and roar.

WINGS ASSEMBLY

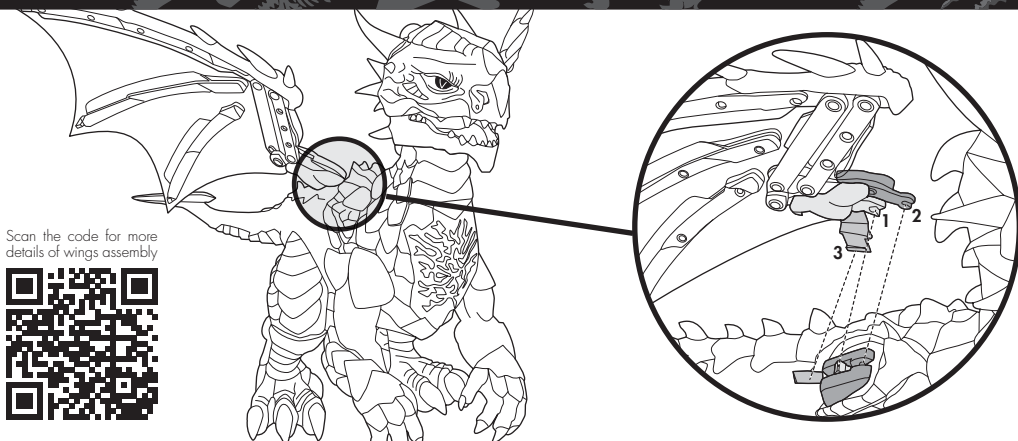

Scan the code for more details of wings assembly



BATTERY INFORMATION

Untamed Legends Dragon Battery Diagram/Installation

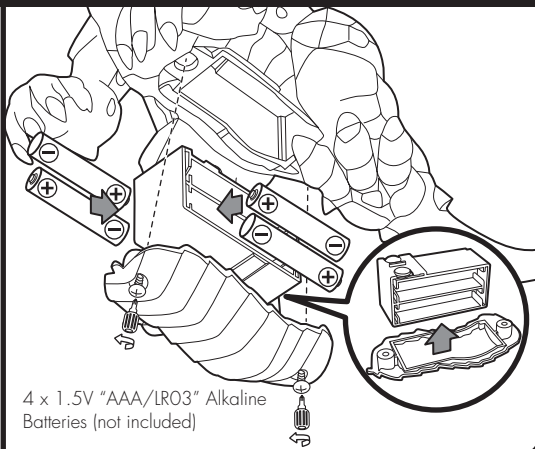

4 x 1.5V "AAA/LR03" Alkaline Batteries (not included)

Installing or changing batteries in Untamed Legends Dragon:

1. Lay your Untamed Legends Dragon down so that the battery compartment faces upwards. Untamed Legends Dragon requires 4 x "AAA/LR03" Alkaline Batteries (not included).
2. Using a Phillips screwdriver (not included) remove the screws on the battery compartment cover.
3. Remove any existing batteries and insert new batteries according to the diagram. Ensure that the positive and negative polarities match the illustrations inside the battery compartment.
4. Replace the battery compartment cover and tighten screws using the screwdriver. Do not over-tighten.

LOW BATTERY INDICATORS:

When the batteries grow weak, the Untamed Legends Dragon will become slower and unresponsive. When this happens, power him "OFF" and replace the batteries.

HOW TO PLAY

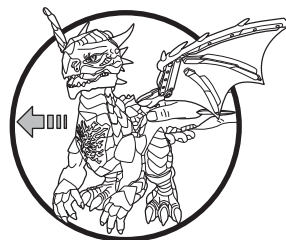

Attack: Hold Vulcan upright & move him forward to make him react with head movements, flapping wings, light-up chest, and sound effects



Screech: Hold Vulcan upright, move him upward or downward to make him screech and flap his wings

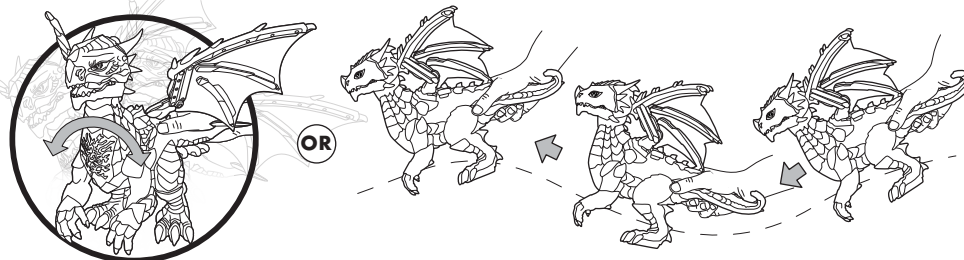

Fly: Move Vulcan up, down, and in a circular motion to see him react with flapping wings and flying sound effects



Pet/tap once, or continuously for different reactions



Clap once to make Vulcan screech and growl



Blow in Vulcan's face to light the fire in his chest. Watch out, he fires "Fireball sounds" at anything that triggers his IR sensors



Clap twice to activate guard mode. Vulcan will flash blue and red and if detected, his wild siren will sound

* Color changing light-up chest