

# pinkfong BABY SHARK™

## Singing Bath Time Bubble Maker

nickelodeon



© Smart Study Co., Ltd. All Rights Reserved. Pinkfong™ and Baby Shark™ are trademarks of Smart Study Co., Ltd., registered or pending rights worldwide.  
© 2019 Viacom International Inc. All Rights Reserved. Nickelodeon is a trademark of Viacom International Inc.



### WowWee Group Limited.

Energy Plaza, 301A-C, 92 Granville Road T.S.T. East, Hong Kong

### WowWee Canada Inc.

3700 Saint Patrick Street, Suite 206, Montreal QC, H4E 1A2, Canada

### Consumer Service:

<https://support.wowwee.com>

## USER MANUAL

Age: 2+

Adult assembly required. Adult supervision required.

## INTRODUCTION

Thank you for purchasing the Official Pinkfong™ Baby Shark™ Singing Bath Time Bubble Maker by WowWee®!

Dive into tub time fun with the Singing Bath Time Bubble Maker! Based on the global song sensation with over 6 billion views, this bath time bubble maker easily suctions to bathtub or tile and features two bath time play modes to help develop imagination, curiosity, and fine motor skills.

Take a few minutes to review this user manual before you start playing!

## FEATURES

### Package Contents:

- 1 x Baby Shark™ Singing Bath Time Bubble Maker;
- 1 x Bubble Blowing Piece
- 1 x User Manual

### Required:

- 2 x "AA" 1.5V LR6 Batteries  
(not included)

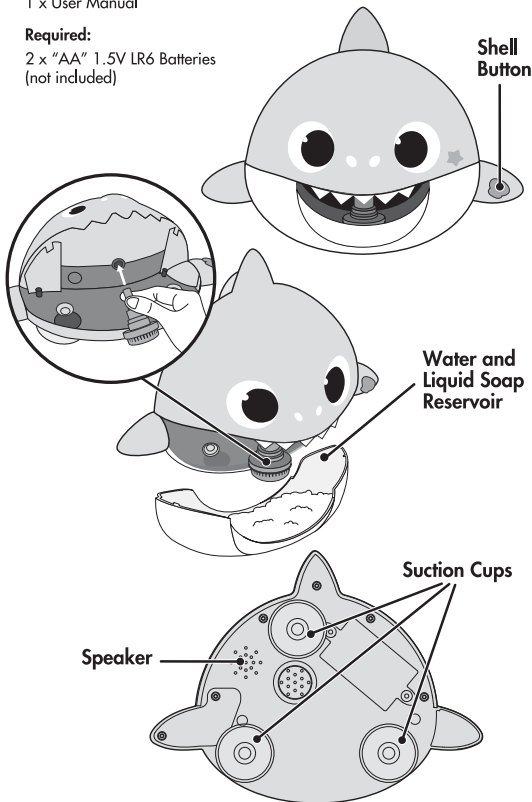

## HOW TO PLAY

### HOW TO FILL:

Pull down the bottom half of the Singing Bath Time Bubble Maker (bottom jaw of face) to carefully remove. Use your fingers to install the Bubble Blowing Piece to the underside of the mouth.

Add approximately 2 teaspoons of liquid soap (not included) to the reservoir and fill the chamber with water. Stir the liquid soap (not included) and water in chamber before use.

Note: most liquid bubble bath and body wash soaps should be suitable.

Close bubble maker by clicking the bottom jaw securely into place.

### POWER ON AND OFF

Press the shell button once to power on.

Once on (mode 1), press the shell button 2 additional times to power off.

### BATH TIME PLAY MODES:

#### Mode 1: Song & Bubbles

After pressing the shell button once, the Singing Bath Time Bubble Maker will begin to play the Baby Shark song and blow bubbles.

#### Mode 2: Bubbles Only

Press the shell button a second time. The Baby Shark song will stop playing but Baby Shark will continue to blow bubbles.

If the bubble maker stops blowing bubbles, it may be time to refill the reservoir with water and liquid soap.

Refer to the section included in this manual for step-by-step instructions.

If the bubble maker stops blowing bubbles and song stops playing, it may be time to replace the batteries. Refer to the section included in this manual for step-by-step instructions.

## BATTERY REPLACEMENT

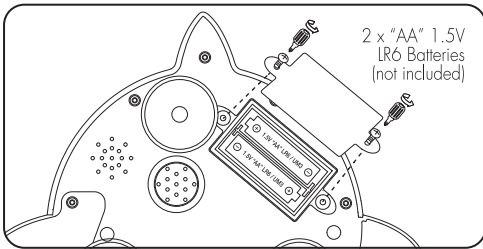

**Battery Diagram/Installation**

1. Lay your Singing Bath Time Bubble Maker down so that the battery compartment faces upwards. The Singing Bath Time Bubble Maker requires 2 x "AA" 1.5V LR6 Batteries (not included).
2. Using a Phillips screwdriver (not included) remove the screws on the battery compartment cover.
3. Remove any existing batteries and insert new batteries according to the diagram. Ensure that the positive and negative polarities match the illustrations inside the battery compartment.
4. Replace the battery compartment cover and tighten screws using the screwdriver. Do not over-tighten.

### IMPORTANT BATTERY INFORMATION:

- Use only fresh batteries of the required size and recommended type.
- Do not mix old and new batteries, different types of batteries [standard (Carbon-Zinc, Alkaline or rechargeable)] or rechargeable batteries of different capacities.
- Remove rechargeable batteries from the toy before recharging them.
- Rechargeable batteries are only to be charged under adult supervision.
- Please respect the correct polarity, (+) and (-).
- Do not try to recharge non-rechargeable batteries.
- Do not dispose of batteries into fire.
- Replace all batteries of the same type/brand at the same time.
- The supply terminals are not to be short-circuited.
- Remove exhausted batteries from the toy.
- Batteries should be replaced by adults.
- Batteries should be recycled or disposed of as per state and local guidelines.
- Protect the environment by not disposing of this product with household waste. Check your local authority for recycling advice and facilities.



### Take note of the following when playing with your Pinkfong™ Baby Shark™ Singing Bath Time Bubble Maker:

- Do not completely submerge the Singing Bath Time Bubble Maker in water.
- As a best practice, we recommend tying up any loose hair when playing with the Singing Bath Time Bubble Maker.
- To avoid discomfort or injury, do not place the Singing Bath Time Bubble Maker on or near a person's head or face.
- Please ensure children are supervised when playing with the Singing Bath Time Bubble Maker to avoid any injury.

## VISIT BABYSHARK.WOWWEE.COM

TO CHECK OUT OTHER OFFICIAL PINKFONG™ BABY SHARK™ TOYS!

Manufactured and distributed by WowWee Group Limited. © Smart Study Co., Ltd. All Rights Reserved. Pinkfong™ and Baby Shark™ are trademarks of Smart Study Co., Ltd., registered or pending rights worldwide. © 2019 Viacom International Inc. All Rights Reserved. Nickelodeon is a trademark of Viacom International Inc. Pinkfong™ and Baby Shark™ registered or pending rights worldwide. "Baby Shark" song arranged by Pinkfong and KizCastle, and performed by KizCastle, Bonmie Catherine Han, Yantzi Michael David, Alison Lea Bender, Sarah Bock and Finn Phoenix.

Customer Service Website: <https://support.wowwee.com>

We recommend that you retain our address for future reference.

Product and colors may vary.

Packaging printed in China

CAN ICES-3(B)/NMB-3(B)

MADE IN CHINA

### CAUTION

Changes or modifications not expressly approved by the party responsible for compliance could void the user's authority to operate the equipment.

### NOTE

This equipment has been tested and found to comply with the limits for a class B digital device, pursuant to part 15 of the FCC rules. These limits are designed to provide reasonable protection against harmful interference in a residential installation. This equipment generates, uses and can radiate radio frequency energy and, if not installed and used in accordance with the instructions, may cause harmful interference to radio communications.

However, there is no guarantee that interference will not occur in a particular installation. If this equipment does cause harmful interference to radio or television reception, which can be determined by turning the equipment off and on, the user is encouraged to try and correct the interference by one or more of the following measures:

- Reorient or relocate the receiving antenna
- Increase the separation between the equipment and receiver
- Connect the equipment into an outlet on a circuit different from that to which the receiver is connected
- Consult the dealer or experienced radio/TV technician for help

This Device complies with Part 15 of the FCC Rules. Operation is subject to the following two conditions: (1) This device may not cause harmful interference, and (2)

This device must accept any interference received, including interference that may cause undesired operation.

For these purposes, the party responsible is:

WowWee USA Inc.

7855 Fay Avenue, Suite 310, La Jolla, CA, USA 92037

1-800-310-3033

For full list of inputs, please visit <http://wowwee.com/babys shark>

For warranty information, please visit <http://wowwee.com/information/warranty>

**WARNING!** This equipment may experience difficulty and/or memory loss when subjected to any electrostatic discharge, radio frequency interference, or sudden power surge/interruption. The user is encouraged to reset the equipment should any of these occur.